

Please insert the dimensions you need in the following schedule, according to the above- mentioned drawing:

Design	<input type="checkbox"/> Single-webbed	<input type="checkbox"/> Double-webbed
d ₁		
b ₂		
c ₁		
d ₂		
e		
f ₁		
f ₂		
f ₃		
f ₄		
g ₁		
g ₂		
m _{max.}		

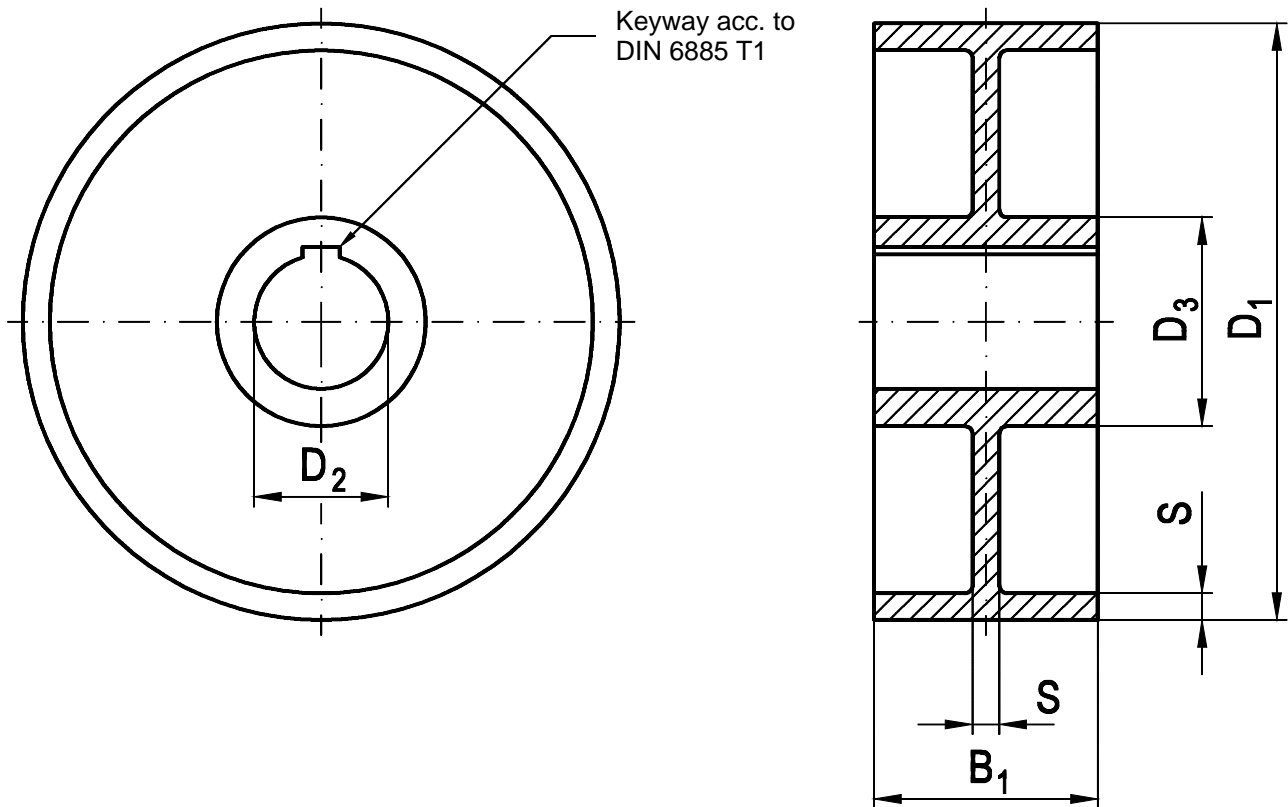

All dimensions in [mm]

D1	B1	Pilot hole	Finish bored	D3	S design	weights (kg) design		Mass moment of inertia J (kgm ²)		max. RPM
						1	2	Ausf. 1	Ausf. 2	
		D2	D2 max ^{H7}		1, 2					min ⁻¹
160	60	18	40	65	8	3,6	3,9	0,013	0,014	4200
200	75	22	50	80	10	6,9	7,5	0,038	0,042	3350
250	95	27	60	95	12	12,9	14,0	0,114	0,124	2700
315	118	37	80	125	15	26,0	28,0	0,358	0,390	2150
400	150	51	90	140	18	48,0	52,0	1,110	1,210	1690
500	190	66	100	160	20	84,0	91,0	3,090	3,370	1350
630	236	66	110	170	25	153,0	167,0	9,520	10,400	1070
710	265	85	120	190	30	228,0	249,0	18,200	19,800	950
800	300	95	140	220	40	375,0	410,0	37,900	41,300	840

Design 1: Casting material spheroidal cast iron GGG 40 manufactured from solid

Brake drums D 75, 100 and 125 as well as special design on request.

Design 2: Steel material C 45 or St 52-3 manufactured from solid

Order example:
5 Brake drums D 400 design 1 material GGG40, finish bored with D 60 and keyway.